

THE SYMPHONY OF  
**BHAVISHA HOMES**

PRESENTING

**RAAGA**



[www.bhavishahomes.com](http://www.bhavishahomes.com)



# ABOUT BHAVISHA HOMES

Bhavisha Homes is committed to delivering quality homes that exceed expectations. With a track record of excellence and innovation. We create communities that enhance the lives of our residents.



# WHY RAAGA

The name "Raaga" was carefully chosen because of its profound significance in the realms of art, music, and philosophy. In life, we often seek to create or inhabit spaces that resonate with our deeper values, emotions, and aspirations. The decision to name this project "Raaga" reflects a deliberate effort to imbue the living experience with a sense of harmony, nuance, and cultural richness with a twist of modern elegance.





SOPHISTICATED URBAN LIVING  
EXPERIENCE LIKE NO OTHER





# PARKING FLOORPLAN



## LEGENDS

1. Mini Forest
2. Cricket Pitch
3. Senior Citizen's Park
4. Children Play Area
5. Basket Ball Court
6. Badminton Court
7. Indoor Gym
8. Party Hall
9. Association Office
10. Store
11. Indoor Game
12. Swimming Pool with Kids Pool
13. Skating Rink
14. Outdoor Gym
15. STP
16. Transformer Yard

No. of Flats	76 Flats
No. of Floors	G+3 Floors
Parking	Stilt Floor
Lifts	2



# FIRST FLOOR PLAN

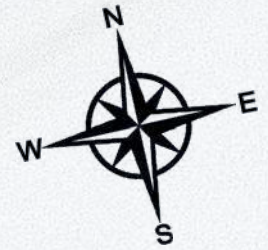



# TYPICAL FLOORPLAN

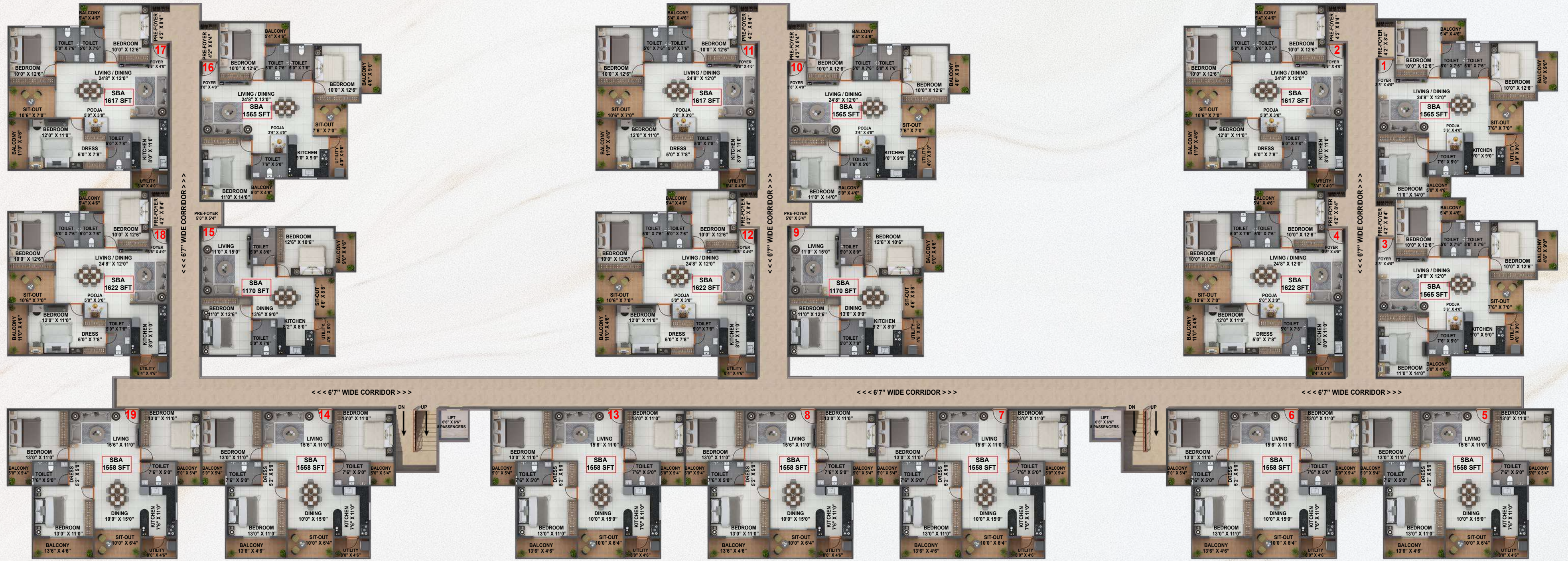
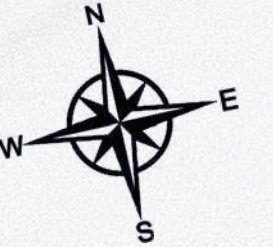



# FLOOR PLAN AND ISOMETRIC VIEW



Flat No	10,16
Ground Floor	10,16
Typical Floor	1,3,10,16
Type	3 BHK
Facing	North
Carpet Area	1165 Sft
SBA	1565 Sft



Flat No	2,17
Ground Floor	2,17
Typical Floor	2,11,17
Type	3 BHK
Facing	North
Carpet Area	1195 Sft
SBA	1617 Sft



Flat No	4,18
Ground Floor	4,18
Typical Floor	4,12,18
Type	3 BHK
Facing	North
Carpet Area	1199 Sft
SBA	1622 Sft







Flat No	5,6,7,8,13,14,19
Ground Floor	5,6,7,8,13,14,19
Typical Floor	5,6,7,8,13,14,19
Type	3 BHK
Facing	North
Carpet Area	1166 Sft
SBA	1558 Sft



Flat No	15
Ground Floor	15
Typical Floor	9,15
Type	2 BHK
Facing	North
Carpet Area	865 Sft
SBA	1170 Sft





Flat No	1,3
Ground Floor	
Type	3 BHK
Facing	North
Carpet Area	1165 Sft
SBA	1565 Sft
Private Terrace	44 Sft



Flat No	11
Ground Floor	
Type	3 BHK
Facing	North
Carpet Area	1195 Sft
SBA	1617 Sft
Private Terrace	107 Sft

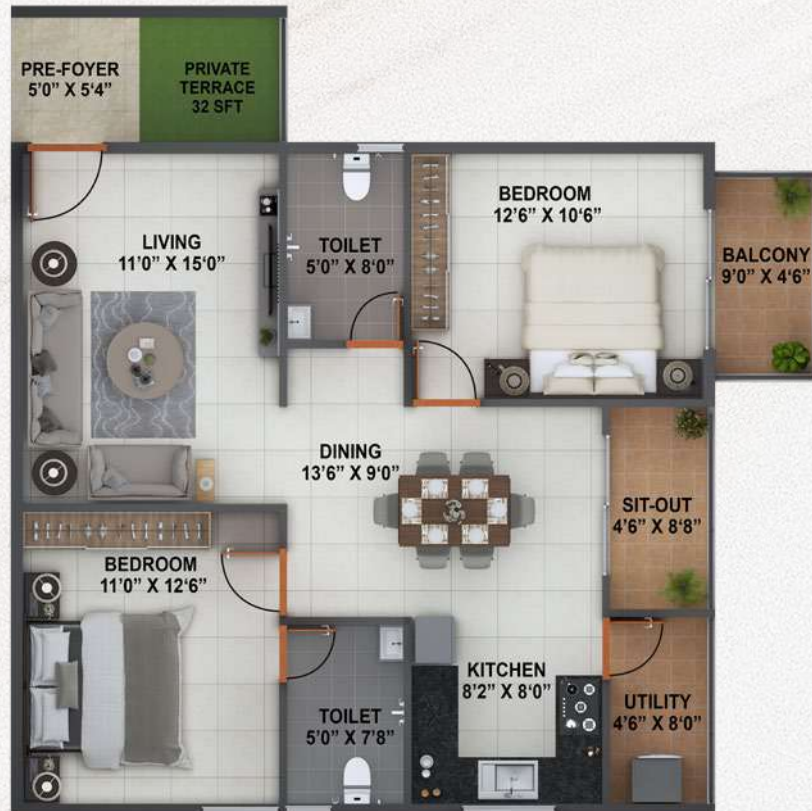

Flat No	9
Ground Floor	
Type	2 BHK
Facing	North
Carpet Area	865 Sft
SBA	1170 Sft
Private Terrace	32 Sft



Flat No	12
Ground Floor	
Type	3 BHK
Facing	North
Carpet Area	1199 Sft
SBA	1622 Sft
Private Terrace	69 Sft



# NEIGHBORHOOD HIGHLIGHTS

EXPLORE THE VIBRANT NEIGHBORHOOD  
SURROUNDING RAAGA APARTMENT ,WITH CONVENIENT  
ACCESS TO SCHOOLS, SHOPPING CENTERS, PARKS, AND MORE.



## EDUCATIONAL INSTITUTE

ISME International School  
Azim Premji University  
Oakridge International School  
Delhi Public School  
Greenwood International School  
Manipal International School  
Indus International School  
Oxford Medical College and Hospital

## HOSPITALS

Swastic Hospital  
Manipal Hospital  
Motherhood Hospital  
Narayana Hrudayalaya

## SHOPPING

Decathlon  
D- Mart  
More Supermarket  
Food City Hyper Market

## TECH PARK

Sable Technology Center  
RGA Tech Park  
RMZ ECO Space  
Infosys  
Wipro New Campus

## FOOD COURT AND RESTAURANT

KFC  
Dominos Pizza Hut  
Mani's Dum Biryani

## MALLS

Forum Prestige City mall (upcoming)  
Total Mall  
Confident Oxygen Mall  
Nature Walk Mall



# AMENITIES

Indulge in the comfort and convenience of life at Raaga Apartments. From a Mini Forest enclave to a range of amenities, there's something for everyone.

- Children Play Area
- Skating Rink
- Badminton Court
- Cricket Practice Pitch
- Landscaped Garden
- Basket ball Court
- Mini Forest
- Outdoor Gym
- Swimming Pool with Kids Pool
- Indoor Gym
- Indoor Games
- Party Hall
- Association Office
- Store
- 24/7 Security with CCTV
- 24/7 Power Backup
- STP





# SPECIFICATION

## Structure

- R.C.C Framed structure with M-25 grade concrete and Fe 500 grade TMT steel, designed as per relevant BIS codes for Earth Quake Resistance (Seismic zone-II) structurally efficient systems implemented

## Walls

- Wall masonry: 6" and 4" solid cement blocks
- Internal walls with 4" Solid concrete blocks

## Plastering

- All internal walls and ceiling plastered and painted with emulsion.
- Exterior walls painted with weather proof external paint

## Doors

- Main entrance door and Bedroom doors are engineered wood door and frame manufacturing door

## Windows

- The three track powder coated Aluminium sliding windows with mosquito mesh and safety grills

## Flooring

- Polished vitrified tiles flooring with 3" skirting in drawing, kitchen, dining and bedrooms
- Anti-skid ceramic tiles for balconies and utilities

## Toilets

- Anti-skid ceramic tiles flooring and Glazed ceramic tiles dadoing up to 7'0".
- Hindware/ Parryware or equivalent make ISI CP and Sanitary Fittings

## Plumbing

- 24hrs Hot and cold water supply lines of CPVC or Equivalent

## Electrification

- Concealed copper wiring and modular switches with adequate power points for light, fan, geyser and exhaust fan

## Communication

- Telephone and TV points in living room

## Generator

- Power back-up provided with load controller for each flat Additional power back-up for water pump and common area lightings

## Lift

- Lift with a capacity of 10 passengers of reputed make

# LOCATION MAP

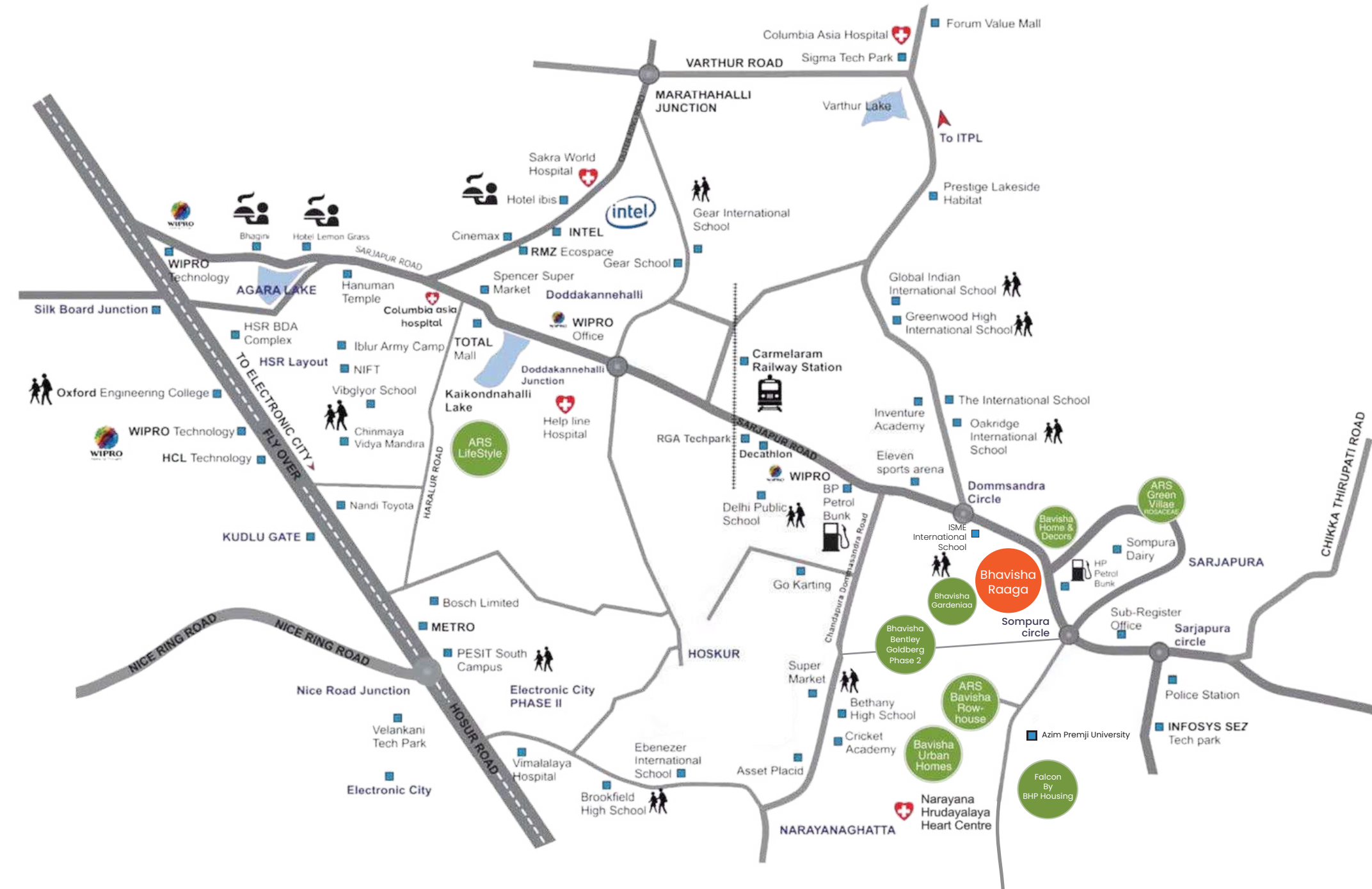



# BHAVISHA PROPERTIES



[bavishaproperties@gmail.com](mailto:bavishaproperties@gmail.com)



[www.bavishahomes.com](http://www.bavishahomes.com)



#001, 3rd Floor, SyNo.55/1, Yamare,  
Sarjapura Road, Bengaluru,  
Karnataka - 562125